

PCB LAYOUT: COMPONENT SIDE
RECOMMENDED PCB THICKNESS: .062/1.57

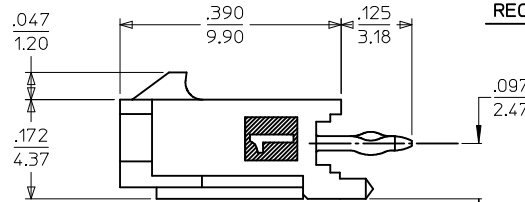

RECEPTACLE #43645

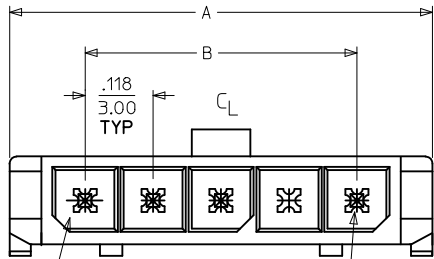
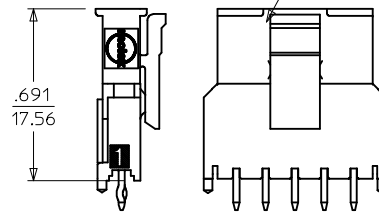

| CKTS | FINISH A | | FINISH B | | FINISH C | | | |
|------|--------------|----------|--------------|------------|--------------|------------|------------|-------|
| | MATERIAL NO: | VOID CKT | MATERIAL NO: | VOID CKT | MATERIAL NO: | VOID CKT | | |
| 02 | 43650-0215 | | 02 | 43650-0216 | 02 | 43650-0217 | | |
| 03 | 43650-0315 | | 03 | 43650-0316 | 03 | 43650-0317 | | |
| 04 | 43650-0415 | | 04 | 43650-0416 | 04 | 43650-0417 | | |
| 05 | 43650-0515 | | 05 | 43650-0516 | 05 | 43650-0517 | | |
| 06 | 43650-0615 | | 06 | 43650-0616 | 06 | 43650-0617 | | |
| 07 | 43650-0715 | | 07 | 43650-0716 | 07 | 43650-0717 | | |
| 08 | 43650-0815 | | 08 | 43650-0816 | 08 | 43650-0817 | | |
| 09 | 43650-0915 | | 09 | 43650-0916 | 09 | 43650-0917 | | |
| 10 | 43650-1015 | | 10 | 43650-1016 | 10 | 43650-1017 | | |
| 11 | 43650-1115 | | 11 | 43650-1116 | 11 | 43650-1117 | | |
| 12 | 43650-1215 | | 12 | 43650-1216 | 12 | 43650-1217 | | |
| 03 | 43650-0330 | 02 | 04 | 43650-0431 | 02,03 | 04 | 43650-0430 | 02,03 |
| 05 | 43650-9915 | 03 | | | | | | |
| 05 | 43650-0530 | 02,04 | | | | | | |
| 06 | 43650-0630 | 02,04,05 | | | | | | |
| 07 | 43650-0730 | 03,04,05 | | | | | | |

NOTES:

- HOUSING MATERIAL: LIQUID CRYSTAL POLYMER, GLASS FILLED, UL94V-0, COLOR: BLACK
TERMINAL MATERIAL: BRASS ALLOY
- FINISH:
A = .000100/(0.00254) MIN. BRIGHT TIN OVER
.000050/(0.00127) MIN. NICKEL
B = .000015/(0.00038) MIN. SELECT GOLD IN CONTACT AREA
.000100/(0.00254) MIN. SELECT MATTE TIN ON SOLDER TAILS
BOTH OVER .000050/(0.00127) NICKEL OVERALL
C = .000030/(0.00076) MIN. SELECT GOLD IN CONTACT AREA
.000100/(0.00254) MIN. SELECT MATTE TIN ON SOLDER TAILS
BOTH OVER .000050/(0.00127) NICKEL OVERALL
- PRODUCT SPECIFICATION: PS-43650
- TRAY PACKAGED : SEE MOLEX DRAWING PK-70873-0811
- MATES WITH MICRO FIT (3.0) RECEPTACLE SERIES 43645
- THIS PART CONFORMS TO CLASS 'B' REQUIREMENTS OF PRODUCT SPECIFICATION PS-45499-002.

| | | | | | | | |
|---|--------------------------------------|--|------|--|------------------------------|--|------------------------|
| ADD 43650-0730 EC NO: UCP2012-4331 DRAWN: MSTR0H 2012/06/29 CHKD: SSOUSEK 2012/07/03 APPR: F.SMLTH 2012/07/09 | QUALITY SYMBOLS ▽=0 ▽=0 ▽=0 | GENERAL TOLERANCES (UNLESS SPECIFIED) | | DIMENSION STYLE IN/MM | SCALE --- | DESIGN UNITS METRIC | THIRD ANGLE PROJECTION |
| | | mm | INCH | DRAWN BY SAMIEC | DATE 2000/07/07 | TITLE MICRO-FIT (3.0) SINGLE ROW / VERTICAL THRU HOLE / PEGS / TRAY | |
| REV T1 | DESCRIPTION | ANGULAR ±1/2° | | MATERIAL NO. SEE CHART | DOCUMENT NO. SD-43650-006 | SHEET NO. 1 OF 1 | |
| | | DRAFT WHERE APPLICABLE MUST REMAIN WITHIN DIMENSIONS | | THIS DRAWING CONTAINS INFORMATION THAT IS PROPRIETARY TO MOLEX INCORPORATED AND SHOULD NOT BE USED WITHOUT WRITTEN PERMISSION | | | |

| CKTS | A | B | C |
|------|-----------------------|-----------------------|-----------------------|
| 2 | $\frac{.380}{9.65}$ | $\frac{.118}{3.00}$ | $\frac{.354}{9.00}$ |
| 3 | $\frac{.498}{12.65}$ | $\frac{.236}{6.00}$ | $\frac{.472}{12.00}$ |
| 4 | $\frac{.616}{15.65}$ | $\frac{.354}{9.00}$ | $\frac{.591}{15.00}$ |
| 5 | $\frac{.734}{18.64}$ | $\frac{.472}{12.00}$ | $\frac{.709}{18.00}$ |
| 6 | $\frac{.852}{21.64}$ | $\frac{.591}{15.00}$ | $\frac{.827}{21.00}$ |
| 7 | $\frac{.970}{24.64}$ | $\frac{.709}{18.00}$ | $\frac{.945}{24.00}$ |
| 8 | $\frac{1.088}{27.64}$ | $\frac{.827}{21.00}$ | $\frac{1.063}{27.00}$ |
| 9 | $\frac{1.206}{30.63}$ | $\frac{.945}{24.00}$ | $\frac{1.181}{30.00}$ |
| 10 | $\frac{1.325}{33.66}$ | $\frac{1.063}{27.00}$ | $\frac{1.299}{33.00}$ |
| 11 | $\frac{1.443}{36.65}$ | $\frac{1.181}{30.00}$ | $\frac{1.417}{36.00}$ |
| 12 | $\frac{1.561}{39.65}$ | $\frac{1.299}{33.00}$ | $\frac{1.535}{39.00}$ |